



October 13-15, 2017



2003 STX SHOOTOUT
@ Compton Family Ice Arena

TEAM GUIDE

University of Notre Dame



2003 BANTAM MAJOR SCHEDULE



DIVISION A

A1. Chicago Mission	C1. New Jersey Colonials
A2. Little Caesars	C2. Mid Fairfield Jr Rangers
A3. Compuware	C3. Los Angeles Jr. Kings
A4. Pittsburgh Pens Elite	C4. Ottawa Junior 67s

DIVISION C

DIVISION B

B1. Gentry Galaxy	D1. Virtua Hockey
B2. Team Wisconsin	D2. Huron Perth Lakers
B3. Rochester Monarchs	D3. Brantford 99ers
B4. Boston Jr. Eagles	D4. Mississauga Reps

DIVISION D

FORMAT

2003 Division will comprise of four (4) brackets of four (4) teams each. Division A will crossover and play Division C and Division B will crossover and play Division D for four (4) round robin games. At the conclusion of round robin play, teams will be ranked one through four within their bracket. Each team will play a fifth and final game on Sunday with a similar finisher in a different bracket (A vs D, B vs C).

ICE FACILITY CODE

COMPTON FAMILY ICE ARENA	
CFIA Lefty Smith Rink	Lefty
CFIA Olympic Rink	Olympic
THE ICE BOX SKATING RINK	
Ice Box 1	Ice Box 1
Ice Box 2	Ice Box 2

FRIDAY, OCTOBER 13

<u>Start</u>	<u>End</u>	<u>Rink</u>	<u>Home</u>	<u>Away</u>
7:20am	8:50am	Olympic	A2. Little Caesars	C2. Mid Fairfield Jr Rangers
7:30am	9:00am	Ice Box 1	A3. Compuware	C3. Los Angeles Jr. Kings
8:00am	9:30am	Lefty	A1. Chicago Mission	C1. New Jersey Colonials
8:00am	9:30am	Ice Box 2	A4. Pittsburgh Pens Elite	C4. Ottawa Junior 67s
9:00am	10:30am	Olympic	B1. Gentry Galaxy	D1. Virtua Hockey
9:10am	10:40am	Ice Box 1	B2. Team Wisconsin	D2. Huron Perth Lakers
10:40am	12:10pm	Olympic	B3. Rochester Monarchs	D3. Brantford 99ers

11:00am	11:50am	Lefty	Denver Pre Game Skate	
12:00pm	1:00pm	Lefty	Notre Dame Pre Game Skate	
12:20pm	1:50pm	Olympic	B4. Boston Jr. Eagles	D4. Mississauga Reps
1:15pm	2:45pm	Lefty	C3. Los Angeles Jr. Kings	A2. Little Caesars
2:55pm	4:25pm	Lefty	C2. Mid Fairfield Jr Rangers	A1. Chicago Mission
3:00pm	4:30pm	Olympic	C4. Ottawa Junior 67s	A3. Compuware
3:45pm	5:15pm	Ice Box 1	D2. Huron Perth Lakers	B1. Gentry Galaxy
4:40pm	6:10pm	Olympic	C1. New Jersey Colonials	A4. Pittsburgh Pens Elite
5:30pm	7:00pm	Ice Box 1	D4. Mississauga Reps	B3. Rochester Monarchs
6:20pm	7:50pm	Olympic	D3. Brantford 99ers	B2. Team Wisconsin
8:00pm	9:30pm	Olympic	D1. Virtua Hockey	B4. Boston Jr. Eagles
7:35pm	COLLEGE GAME		Notre Dame vs Denver	

SATURDAY, OCTOBER 14

<u>Start</u>	<u>End</u>	<u>Rink</u>	<u>Home</u>	<u>Away</u>
7:15am	8:45am	Lefty	A3. Compuware	C1. New Jersey Colonials
7:30am	9:00am	Olympic	A2. Little Caesars	C4. Ottawa Junior 67s
7:30am	9:00am	Ice Box 2	A4. Pittsburgh Pens Elite	C2. Mid Fairfield Jr Rangers
9:00am	10:30am	Ice Box 1	B1. Gentry Galaxy	D3. Brantford 99ers
9:10am	10:40am	Olympic	B4. Boston Jr. Eagles	D2. Huron Perth Lakers
9:10am	10:40am	Ice Box 2	A1. Chicago Mission	C3. Los Angeles Jr. Kings
9:00am	10:00am	Lefty	Denver Pre Game Skate	
10:30am	11:45am	Lefty	Notre Dame Pre Game Skate	
10:50am	12:20pm	Olympic	B2. Team Wisconsin	D4. Mississauga Reps
12:20pm	1:50pm	Lefty	C2. Mid Fairfield Jr Rangers	A3. Compuware
12:30pm	2:00pm	Olympic	B3. Rochester Monarchs	D1. Virtua Hockey
1:00pm	2:30pm	Ice Box 1	C1. New Jersey Colonials	A2. Little Caesars
2:00pm	3:30pm	Lefty	C3. Los Angeles Jr. Kings	A4. Pittsburgh Pens Elite
2:40pm	4:10pm	Ice Box 1	D3. Brantford 99ers	B4. Boston Jr. Eagles
4:00pm	5:30pm	Olympic	D4. Mississauga Reps	B1. Gentry Galaxy
4:20pm	5:50pm	Ice Box 1	C4. Ottawa Junior 67s	A1. Chicago Mission
5:10pm	6:40pm	Ice Box 2	D1. Virtua Hockey	B2. Team Wisconsin
5:40pm	7:10pm	Olympic	D2. Huron Perth Lakers	B3. Rochester Monarchs
6:05pm	COLLEGE GAME		Notre Dame vs Denver	

SUNDAY, OCTOBER 15

<u>Start</u>	<u>End</u>	<u>Rink</u>	<u>Home</u>	<u>Away</u>
7:30am	9:00am	Lefty	A2nd place	D2nd place
7:40am	9:10am	Olympic	A4th place	D4th place
9:10am	10:40am	Lefty	B2nd place	C2nd place

9:20am	10:50am	Olympic	B4th place	C4th place
10:50am	12:20pm	Lefty	A1st place	D1st place
11:00am	12:30pm	Olympic	A3rd place	D3rd place
12:30pm	2:00pm	Lefty	B1st place	C1st place
12:40pm	2:10pm	Olympic	B3rd place	C3rd place



LOCKER ROOM TOUR SCHEDULE



SUNDAY, OCT 15 - LOCKER ROOM TOURS

9:20am	A2nd pl & D2nd pl	
9:45am	A4th pl & D4th pl	
11:00am	B2nd pl & C2nd pl	
11:20am	B4th pl & C4th pl	
12:45pm	A1st pl & D1st pl	
1:00pm	A3rd pl & D3rd pl	
2:15pm	B1st pl & C1st pl	
2:30pm	B3rd pl & C3rd pl	



COLLEGE GAME NIGHT DESIGNATIONS



FRIDAY

- A1. Chicago Mission
- A3. Compuware
- C1. New Jersey Colonials
- C3. Los Angeles Jr. Kings
- B1. Gentry Galaxy
- B3. Rochester Monarchs
- D2. Huron Perth Lakers
- D4. Mississauga Reps

SATURDAY

- A2. Little Caesars
- A4. Pittsburgh Pens Elite
- B2. Team Wisconsin
- B4. Boston Jr. Eagles
- C2. Mid Fairfield Jr Rangers
- C4. Ottawa Junior 67s
- D1. Virtua Hockey
- D3. Brantford 99ers



FACILITY ADDRESSES



COMPTON FAMILY ICE ARENA

100 Compton Family Ice Arena

Notre Dame, IN 46556

(574) 631-1166

ICE BOX SKATING RINK

1421 South Walnut Street

South Bend, IN 46619

(574) 288-3300



DIRECTIONS – COMPTON FAMILY ICE ARENA



From Indiana Toll Road:

Use Exit 77 (South Bend/Notre Dame). Turn right (south) onto SR 933/Bus.31. Go south - at Angela Rd. turn left (east). Go East, turn left (north) onto Joyce Dr. Compton Family Ice Arena is located on the right (Corner of Joyce and Angela). Bus loading/unloading will be at the North/Main Entrance of the arena.

From Indianapolis:

Follow U.S. 31 North. That becomes SR 933/Bus.31 just south of South Bend. Proceed through South Bend and continue north. Turn Right (east) onto Angela Rd. Go east, turn left (north) onto Joyce Dr. Compton Family Ice Arena is located on the right (corner of Joyce and Angela). Bus loading/unloading will be at the North/Main Entrance of the arena.

From O'hare Airport:

Take Route 190 east out of O'Hare to Route 90 east (Kennedy Expressway) toward downtown Chicago. Merges with Route 94 south (Dan Ryan Expressway). Take Skyway exit off the Dan Ryan and remain on Route 90 to Indiana Toll Road. Eventually merges with Route 80. Use Exit 77 (South Bend/Notre Dame).

Notes:

An alternative route: Take Route 190 east out of O'Hare to Interstate 294 south (Tri-State Tollway) and follow the signs for 80/294 and then Interstate 80-90 (Indiana Toll Road). Use Exit 77 (South Bend/Notre Dame).



Map and Parking Information

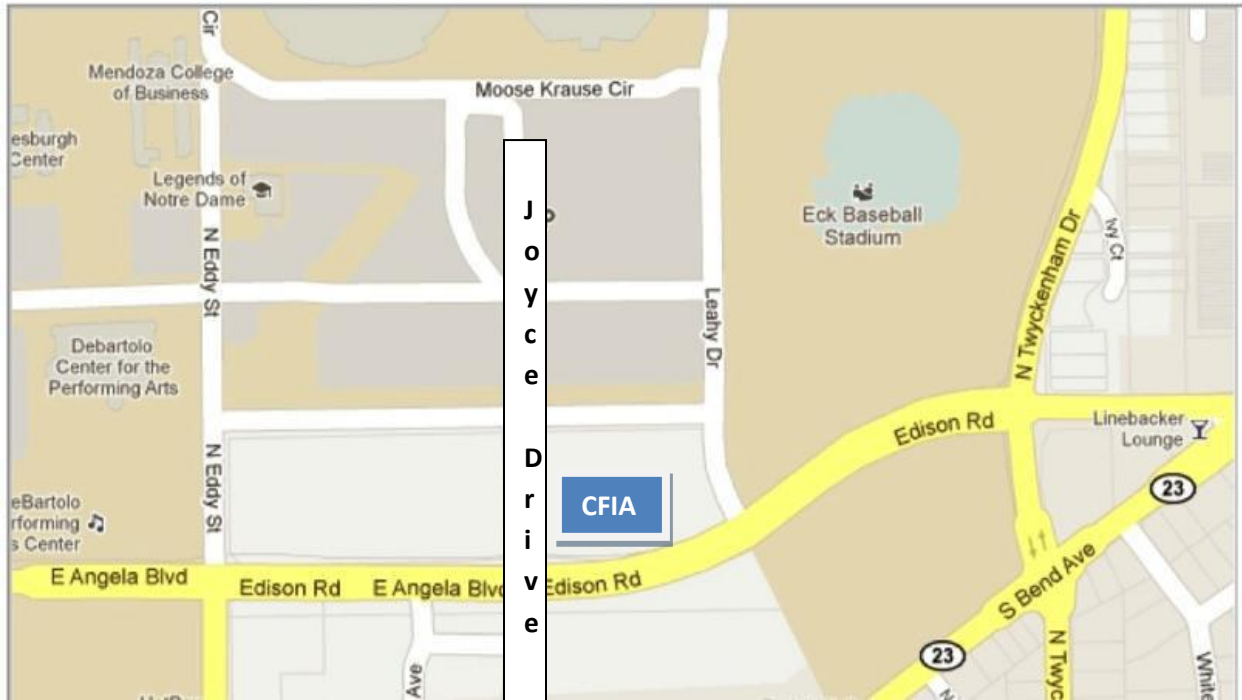

General Parking:

All Vehicles can park in any of the Joyce Center or Compton Family Ice Arena Lots.



Arena Details



Opened in October 2011, the Compton Family Ice Arena anchors the south edge of campus, adjacent to the Joyce Center and west of the Irish track and field facility. The state-of-the-art arena houses two ice rinks and was designed to support the Notre Dame hockey programs and those in the local community. The facility was made possible by a generous lead gift from Kevin and Gayla Compton, who also own the San Jose Sharks of the National Hockey League (NHL). With its eye-catching, barrel-vaulted roof and bow trusses, the main arena has two levels with a capacity of 5,000—both seated and standing room combined—with the majority of the seats a comfortable, chair-back style. The student section and hockey band seating are located on the west end of both levels. O’Brien’s, the exclusive club for Fighting Irish Hockey games, is located on the upper level, as well as mezzanine level seating and the media center. Open concourses on both levels provide ample standing room.

The Charles W. “Lefty” Smith Jr. Rink, the 200' x 90' playing surface of the main arena, honors the first coach in the Notre Dame hockey program. The Olympic-size rink can be divided into smaller rinks to be used by the Irish Youth Hockey League (IYHL) and support the USA Hockey Athlete Development Model (ADM), figure skating, public skating, and broomball. The building also houses numerous offices, locker rooms, and training facilities.





Arena Map

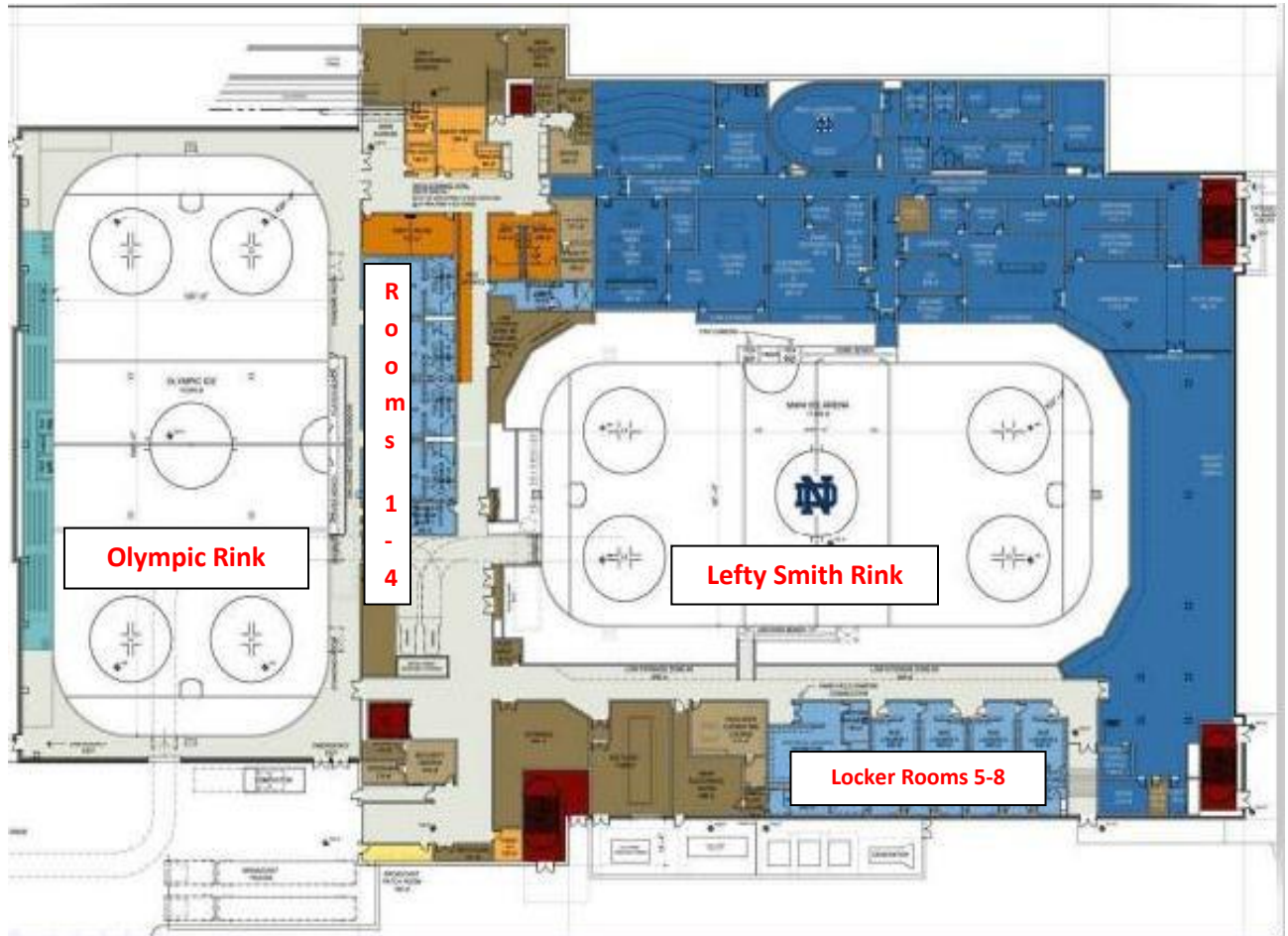



Local Hospitals



Memorial Hospital - Level II Trauma Center

615 N. Michigan St.
South Bend, IN 46601
574-647-1000

www.qualityoflife.org

Directions from CFIA: Turn West (right) onto Angela/Edison from CFIA. When you get to SR933/Business 31, turn South (left). Travel .7 miles and Memorial Hospital will be on the right.

St. Joseph Regional Medical Center

5215 Holy Cross Parkway (Intersection of Main & Douglas)
Mishawaka, IN 46545
574-335-5000

www.sjmed.com

Directions from CFIA: Turn East (left) onto Angela/Edison from CFIA. When you get to SR-23, turn North (Left). Travel to Douglas Rd., turn East (right). Travel 1.9 miles. St. Joseph Regional Medical Center will be on the right.

MedPoint

6913 North Main St.
Granger, IN 46530
574-647-1550

Directions from CFIA: Turn East (left) onto Angela/Edison from CFIA. When you get to SR-23, turn North (left). Travel 2.7 miles to Cleveland Rd., turn East (right). Travel 0.6 miles to Main St, turn South (right). MedPoint will be on the right.



South Bend/Mishawaka Map

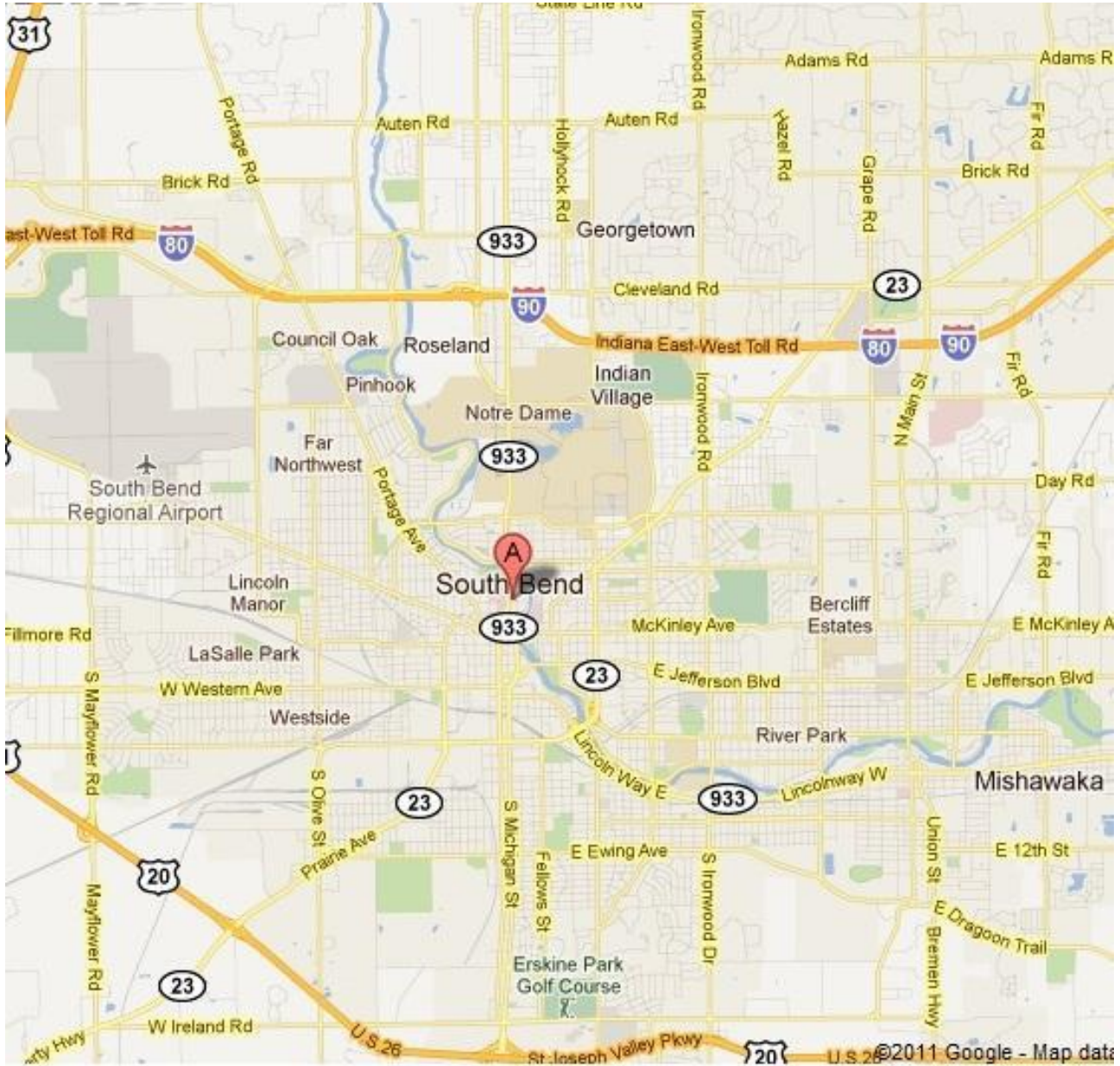



Area Restaurants

**Parisi's Italian Ristorante**

1412 South Bend Ave.
574-232-4244
0.5 miles from CFIA

Hot Box Pizza

1234 Eddy St.
574-246-9445
0.2 miles from CFIA

Five Guys Burgers & Fries

1233 Eddy St. #110
574-234-1800
0.2 miles from CFIA

The Mark Dine & Tap

1234 Eddy St. #111
574-204-2767
0.2 miles from CFIA

McAllister's Deli

1130 Angela Blvd. #102
574-232-8560
0.2 miles from CFIA

Rocco's Pizza

537 N. Saint Louis Blvd
574-233-2464
0.8 miles from CFIA

Between the Buns

1803 South Bend Avenue
574-247-9293
0.8 Miles from CFIA

Barnaby's

713 E. Jefferson Ave
574-288-4981
1.4 miles from CFIA

Original Pancake House

1430 N. Ironwood Dr.
574-232-3220
1.1 miles from CFIA

Tippecanoe Place

620 W. Washington St.
574-234-9077
1.7 miles from CFIA

Main Street Pub & Grill

2046 South Bend Ave
574-271-9895
0.9 miles from CFIA

Nick's Patio

1710 N. Ironwood Dr.
574-277-7400
1.1 miles from CFIA

Hacienda Mexican

1501 N. Ironwood Dr.
574-272-5922
1.0 miles from CFIA

Mulligan's Bar & Grill

1705 South Bend Ave.
574-277-5666
0.2 miles from CFIA

Studebagels

1801 South Bend Ave
574-277-4440
0.8 miles from CFIA

Carmela's at Macri's

214 N. Niles Ave
574-280-4824
1.2 miles from CFIA

Maury's Pat's Pub

901 West 4th St.
Mishawaka, IN
574-259-8282

Jimmy John's

54570 N. Ironwood
574-277-8500
1.1 miles from CFIA

Chipotle Mexican Grill

1250 N. Eddy #101
574-251-0175
0.2 miles from CFIA

Einstein Bagels

2019 South Bend Ave
574-272-2622
0.9 miles from CFIA

Domino's Pizza

1627 Edison Rd.
574-271-0300
0.1 miles from CFIA



Area Attractions



University Park Mall

www.simon.com/mall/?id-192

6501 N. Grape Rd. Mishawaka, IN 46545

College Football Hall of Fame

www.collegefootball.org

111 South St. Joseph St. South Bend, IN

1-800-440-FAME

Potawatomi Zoo

www.potawatomizoo.org

500 S. Greenlawn South Bend, IN 46615

574-235-9800

Morris Performing Arts Center

www.morriscenter.org

211 N. Michigan St. South Bend, IN 46601

574-235-9190

Studebaker Museum

www.studebakermuseum.org

201 S. Chapin St. South Bend, IN 46601

574-235-9714

**UNIVERSITY OF NOTRE DAME COMPTON FAMILY ICE ARENA
WAIVER, RELEASE, AND INDEMNIFICATION AGREEMENT FOR MINORS (YOUNGER THAN AGE 18)
2017-2018 (July 1 – June 30)**

I, _____, am the parent or guardian of a minor child, _____, who will be participating in ice skating, ice hockey, and/or broomball activity (collectively "Activity") at the Compton Family Ice Arena ("Arena") at the University of Notre Dame du Lac, Notre Dame, Indiana (the "University") during the period of time starting with the date of my signature below through June 30, 2018. I am fully aware that my child's participation in this Activity is totally voluntary. In consideration of the University's agreement to permit my son or daughter to participate in the Activity, the receipt and sufficiency of which consideration is hereby acknowledged, I agree as follows:

1. I, individually, and on behalf of my minor child and our respective heirs, successors, assigns, and personal representatives, hereby release, acquit and forever discharge the University and its employees, agents, servants, officers, trustees, and representatives (in their official and individual capacities) from any and all liability whatsoever, excluding liability for the University's sole negligence, for any and all damages, losses or injuries (including death, mental anguish or emotional distress) to myself, my child and/or property, including but not limited to any claims, demands, actions, causes of action, damages, costs, expenses (including hospital and medical expenses) and attorneys' fees, which arise out of, occur during, or result from my child's participation in the aforementioned Activity, including travel to and from the University and including without limitation any loss, claim, demand or suit that my child might assert once he/she attains the age of majority.

2. I, individually, and on behalf of my minor child and our respective heirs, successors, assigns, and personal representatives, hereby agree to indemnify, defend and hold harmless the University and its employees, agents, servants, officers, trustees and representatives (in their individual and official capacities) from any and all liability, loss or damages incurred or sustained (including injury or damage to persons and/or property) as a result of any claims, demands, damages, actions, causes of action, judgments, costs, expenses (including hospital and medical expenses) and/or attorneys' fees, which result from, arise out of, or relate to my child's participation in the aforementioned Activity or arising out of his or her travel to and from the University.

3. I agree that this Waiver, Release, and Indemnification Agreement is governed by the laws of the State of Indiana and is intended to be as broad and inclusive as permitted by the laws of the State of Indiana. If any portion hereof is held invalid, it is agreed that the balance hereof shall, notwithstanding, continue in full legal force and effect. In the event of any cause of action related to the Activity, I agree that jurisdiction lies with the Superior Court of St. Joseph County, Indiana or the U. S. District Court of Northern District of Indiana.

4. I hereby acknowledge and accept that there are certain risks, known and unknown, including bodily injury and death, inherent in my child's participation in ice skating, the game of ice hockey, and/or the games of broomball or curling. I, on my own behalf and on behalf of my minor child, have knowingly and voluntarily decided to assume the risk of these inherent dangers in consideration of the University's permission to allow my minor child to participate in the aforementioned Activity. I hereby release and discharge the University from any and all negligence, excluding the University's sole negligence, in connection with my child's participation in the Activity, including travel to and from the University. I hereby acknowledge and agree that the University may permit my child to engage in any ice skating, ice hockey, curling or broomball activity at the Arena and that I assume sole responsibility for preventing my child from engaging in any ice skating, ice hockey, curling or broomball activity in which I do not want him/her to participate.

5. I hereby agree that, if my child engages in any ice hockey or broomball activity at the Arena, I shall have sole responsibility for ensuring that he/she will wear at all times while on the ice rink surface all protective equipment required by the Arena for such activity, including a helmet that meets the Arena's requirements. I hereby acknowledge that non-compliance with any such requirement may result in my child's ejection from the Arena on the date(s) on which the requirement is violated.

6. I hereby represent and warrant that, if my child will engage in any ice hockey activity at the Arena, he/she will be a current, registered member of USA Hockey, Inc. at the time of that ice hockey activity. I further agree that I shall prevent and shall have the sole responsibility for preventing my child from engaging in any ice hockey activity at the Arena during any period of time that my child is not a registered member of USA Hockey, Inc.

7. **By signing this Waiver, Release, and Indemnification Agreement, I hereby acknowledge and represent that I have read this entire document, that I understand its terms and provisions, that I understand that it affects my legal rights and those of my child, that it is a binding Agreement, and that I have signed it knowingly and voluntarily.**

_____	_____	_____
Parent or Guardian Signature	Parent or Guardian Name (Printed)	Date
USA Hockey registration Confirmation Number (from USAH registration receipt): _____		
Learn To Skate USA Membership # (from learntoskateusa.com): _____		
Date of Birth: _____ Zip Code (used to register w/ USA Hockey): _____		
Parent Email Address: _____ Cell Phone #: _____		